



Generator Technical Data Sheet for

Model: PHG165ivOS



GENERATORS AND UPS



- Intelligent Auto-Start Controller with Generator
- Monitoring and Protection Systems Suitable for Remote Starting or Connection with shentonggroup AMF Panel
- Battery Trickle Charger
- Thermostatically controlled Engine Heater
- Long Range Bundled Base Fuel Tank
- Ability to be Customised to Specific Requirements
- Output Circuit Breaker

GENERAL

The Powerhouse Series which ranges from 10 to 2230kVA, is built to a world-class standard and these remarkably competitive standby generators provide the most cost-effective solution for 'standard package' requirements.

A first-class range of diesel-powered generators for prime and standby power application which feature reliable components from leading manufacturers, these are premium products upon which your company can build its reputation.

Model PHG165ivOS

Standby Power	kVA	165
	kW	132
Prime Power	kVA	150
	kW	120
Rated Speed	r.p.m	1500
Voltage	V	400/230
Rated Power Factor	Cos Phi	0.8
Data Sheet Number	PHG165ivOS NS Rev 4	

Prime: This rating is for the supply of continuous electrical power (at variable load) in lieu of commercially purchased power. There is no limitation on the annual hours of operation and 10% overload power can be supplied for one hour in twelve hours.

Standby: This rating is for the supply of continuous electrical power (at variable load) in the event of a utility power failure. No overload is permitted. Max rating, is available for one in twelve hours

Note: Standard reference conditions: 25deg C (77deg F) air inlet temperature, 152.4m (500feet) above sea level, 60% relative humidity. All engine performance data based on the above mentioned maximum continuous ratings. Fuel consumption data at full load for diesel fuel with specific gravity of 0.85 and conforming to BS2869: 1998, class A2.

In line with our policy of continuous development, we reserve the right to change specification without notice.



Generator Technical Data Sheet for

Model: PHG165ivOS



GENERATORS AND UPS

**IVECO
MOTORS**



TENGINE

Rated Output	kWm	154.7
Manufacturer		IVECO-FPT
Model		N67TM4A
Engine Type		Diesel 4 Strokes-Cycle
Aspiration Type		Turbo charged
Cylinders Arrangement		6 in line
Bore & Stroke	mm	104 x 132
Displacement	L	6.7
Cooling System		Water
Compression Ratio		17.5:01
Fuel Consumption 100% PRP	l/h	36.6
Fuel Consumption 75% PRP	l/h	29.4
Fuel Consumption 50% PRP	l/h	18
Total Oil Capacity	L	17.2
Total Coolant Capacity	L	25.5
Governor	Type	Mechanical
Air Filter	Type	Dry Paper Cartridge
Battery Capacity	Ah	176
Battery Voltage	V	12

FPT Industrial is the Brand of CNH Industrial dedicated to the development, production, sale and assistance of powertrains for On Road, Off Road, Marine and Power Generation applications. Today FPT Industrial is one of the leading world players in engines, axles and transmissions for the Industrial sector, ranking among the first four manufacturers worldwide in the 2- to 20-liter Diesel engine segment.



Generator Technical Data Sheet for

Model: PHG165ivOS



GENERATORS AND UPS



ALTERNATOR

Manufacturer		Mecc-Alte
Model		ECP 34-1L/4c
Poles		4
Frequency	Hz	50
Insulation Class		H
Efficiency at 75% load class H 400v	%	93.7
Reactance Xd'' Unsaturated	%	5.8
Short Circuit Current Capacity	%	>300
Heat Dissipation 400v	W	8755
Radio Interference		EN61000-6-3, EN61000-6-2
Waveform Distortion (THD) at Full Load	%	1.9%
Enclosure (according IEC-34-5)		IP 21
Weight of Complete Generator	Kg	423
Cooling Air Requirement	m3/min	29.2
Alternator Rating Overload	%	10% for 1 in 6 hours
Overload per 20 sec	%	300
Exciter System		Auxilliary Winding
Voltage Regulator		DSR
Voltage regulation Performance +/-	%	1
Coupling		Flexible Disk

Mecc Alte has sixty years of experience in the electromechanical field, and is today at its height in the world production of synchronous alternators. Committed daily to research, development and updating activities, Mecc Alte is a testimony to constant improvement in all areas such as technology, organisation and quality. The company has ISO 9001 certification, awarded in 1996 and ISO 14001 since 2010. With 54.000 square meters of factory area, almost 850 employees and a turnover of approximately 130 million euro, Mecc Alte is a well-established company ready to challenge the markets in every product sector.

Generator Technical Data Sheet for

Model: PHG165ivOS



GENERATORS AND UPS

APPLICATION DATA

Exhaust System

Maximum Exhaust Temperature	°C	497
Exhaust Gas Flow	M3/min	23.56
Maximum Allowed Back Pressure	kPa	5

Air Flows

Intake Air Flow	m3/h	586
Cooling Air Flow	m3/s	3.8
Available Air Restriction	Pa	196

Fuel System

Fuel Oil Spec		DIESEL
Fuel Tank Capacity	L	340
Autonomy @ 75% load	Hrs	11

Dimensions/weight

Length	mm	2500
Width	mm	1000
Height	mm	1350
Weight excluding fuel	Kg	1600
Sound Pressure Level @ 7 mtrs	dB(A)	-

Electrical

Output Circuit Breaker	Type	MCCB
	Model	ABB XT3N 250Amp
Full Load Current at 400V .8 p.f.	Amps	238



Generator Technical Data Sheet for

Model: PHG165ivOS



GENERATORS AND UPS



SG7410MKii GENERATOR CONTROLLER

The SG7410MKii is an Auto Start Control Module. Monitoring an extensive number of engine parameters, the modules will display warnings, shutdown and engine status information on the backlit LCD screen, illuminated LEDs, remote PC. The modules include USB, RS232 and RS485 ports as well as dedicated DSENet[®] terminals for system expansion. The module is compatible with electronic (CAN) and non-electronic (magnetic pick up/alternator sensing) engines and offers an extensive number of flexible inputs, outputs and engine protections so the system can be easily adapted to meet the most demanding industry requirements. The full list of features includes enhanced event and performance monitoring, remote communications and dual mutual standby.

CONTROL PANEL DISPLAY FEATURES

Engine RPM	Generator Output Current
Engine Oil Pressure	Earth current
Coolant temperature	Output kW
Battery Volts	Load level %
Run Hours/ No of starts	Output kVA
Fuel level	Power factor
Generator output Voltage	Load kVAR
Frequency	kWh/kVAh/kVArh

SG7410MKii is a branded Deep Sea Electronics controller, customized to shentonggroup's specific requirements. shentonggroup has a long history of collaboration with Deep Sea Electronics, and endorse their products with confidence. Our experience has proved this is the market-leading controller having a perfect mix of complex capability and user simplicity.



Generator Technical Data Sheet for

Model: PHG165ivOS



GENERATORS AND UPS

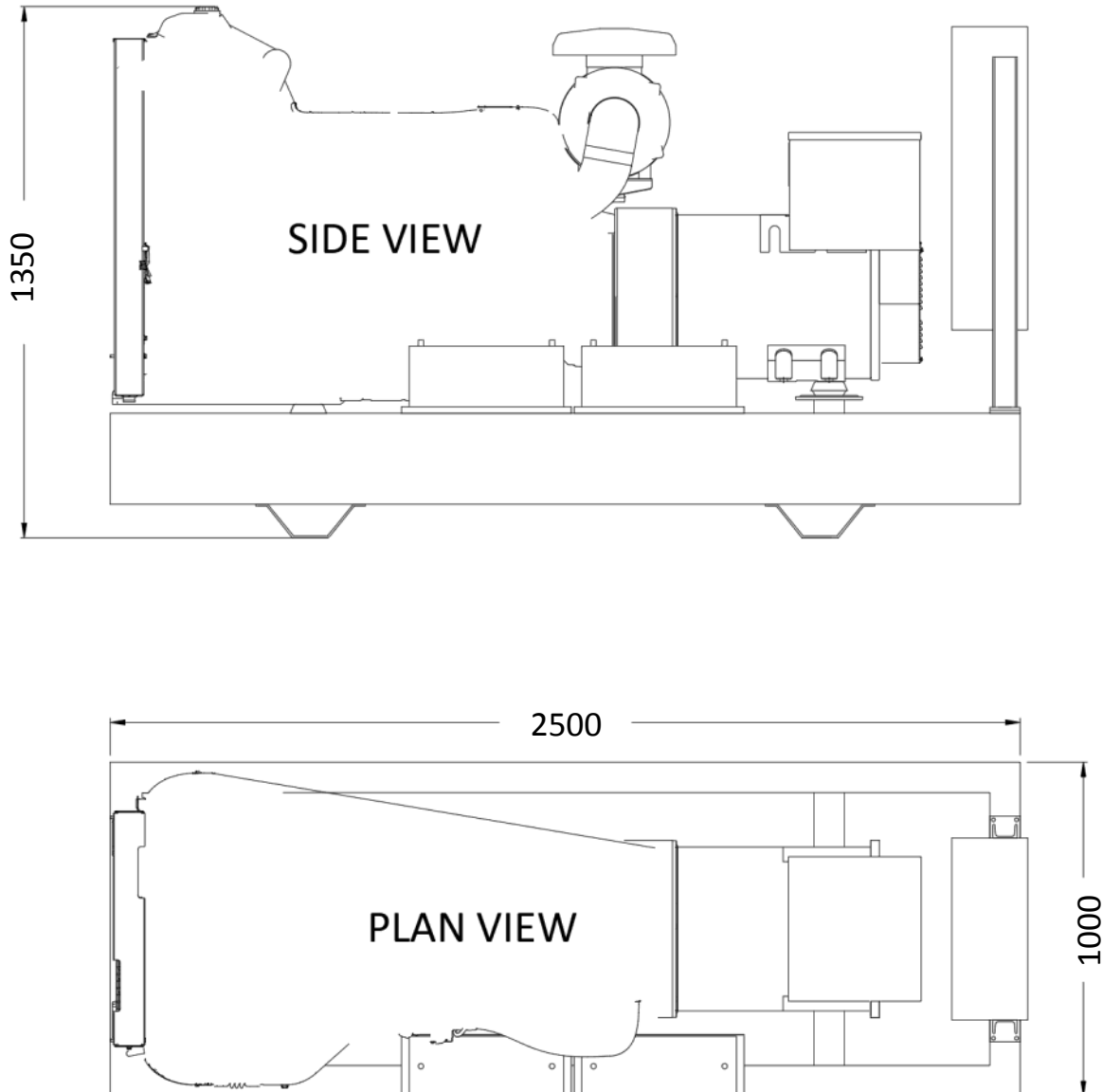

The above illustration is a representation only for preliminary planning. Specific detailed drawings are available on request. In line with our policy of continuous development, we reserve the right to change specifications without notice.